

Floor mounted compact drainage water and effluent box

SaniQ plus - CH140 WA

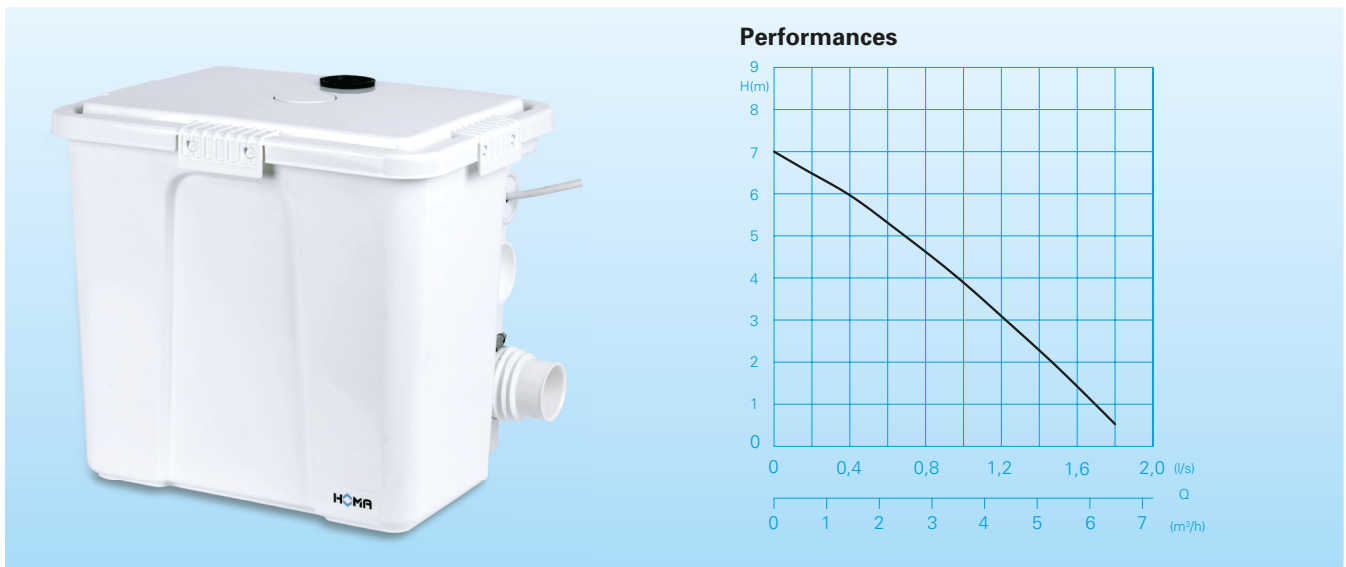

Application

The version with the pump CH140WA also promotes chemically aggressive clear water or wastewater, such as salt water, from water softeners and condensate from condensing boilers. The SaniQ plus is also the ideal solution for subsequent installation of sanitary facilities. The built-in powerful drainage pump operates automatically by a floatswitch control. The discharge pipe with Ø 40 mm minimum diameter can be easily installed with minimum construction work. The SaniQ plus compact design allows installation directly under the hand basin, where space is at a premium.

DIN EN 12050-2: Conformity and design approved and controlled by LGA

Pumped liquid: Domestic drainage water and effluent. Maximum liquid Temperature: 35°C.

Operation: Permanent. (S1)
60°C intermittent (S3-30%)

Technical Data

Curve Nr.	Pump type	Motor P ₁ (kW)	P ₂ (kW)	Nominal current (A)	Discharge	Weight (kg)
①	SaniQ plus - CH140 WA	0,32	0,17	1,4	Ø 40 (DN 32)	7,0

Speed: 2850 rpm
Cable: H07RN-F 3G1

Model W: 230V/1Ph 50Hz
Model CH: for chemically aggressive wastewater

Design

Compact domestic effluent disposal unit comprising:

Collection Tank: Odour-tight plastic collection tank. Maximum utility volume 27 litres. One top inlet Ø 40 mm. Four lateral inlets Ø 50 mm. Discharge Ø 40 mm (DN32) with integrated non-return valve - optional on the left or right site allows flexible connection. Air vent with activated carbon filter

Pump/Motor: Fully submersible, pressure tight electric motor. Insulation class F. Motor protection IP 68. Shaft sealing consisting of a shaft seal and SIC-mechanical seal. Thermal sensors imbedded in the motor winding.

Rotor shaft and motor housing from high quality stainless steel. Open multi-channel impeller, spherical clearance 10 mm.

Pump Operation Control: float switch

Equipment supplied

Collecting tank with pump - fully assembled, washing machine connection, elastic connection pieces, non-return valve, activated carbon filter, 5 m cable and plug

Installation

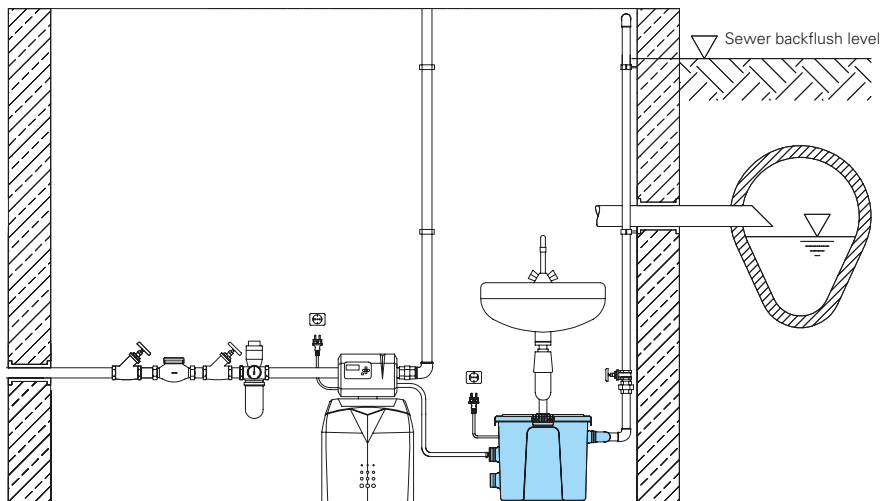

Type	Art.-Nr.
SaniQ plus – CH140WA	9804171

Accessories

Description	Dim.	Part No.
AL3 Alarm unit with level sensor for tanks		1586146
ALWS alarm unit with level sensor for tanks and washing machine off-switch		1586213
Special float switch to reduce switching height. (On ca. 120 mm Off ca. 50 mm)		7300693
Accessories-Kit: Inlet SaniQ plus		860903

Dimensions (all dimensions in mm)

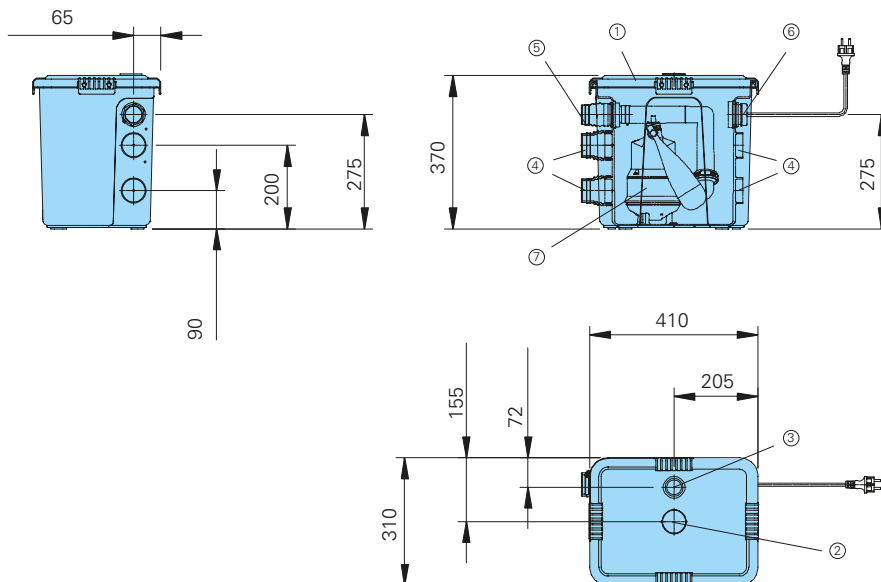

Materials

Collection tank	ABS
Installation kit	Composite
Pump housing	Glass-fibre reinforced synthetic material (composite)
Motor housing	high quality stainless steel
Impeller	Glass-fibre reinforced synthetic material (composite)
Rotor shaft	high quality stainless steel
screws	stainless steel
Seal kit	NBR

- ① Collecting Tank with cover and seal
- ② Air vent with activated carbon filter
- ③ Inlet Ø 40 mm
- ④ Inlet Ø 50 mm
- ⑤ Discharge Ø 40 mm (DN32) with integrated non-return valve
- ⑥ Cable inlet
- ⑦ Pump with float switch

HOMA
P U M P T E C H N O L O G Y

HOMA Pumpenfabrik GmbH
P.O.Box 22 63, D-53814 Neunk.-Seelscheid
Tel. +49 (0) 22 47/702-0, Fax +49 (0) 22 47/702-44
e-mail: info@homa-pumpen.de
www.homapumps.com